

PACIFIC ASSEMBLY INSTRUCTIONS

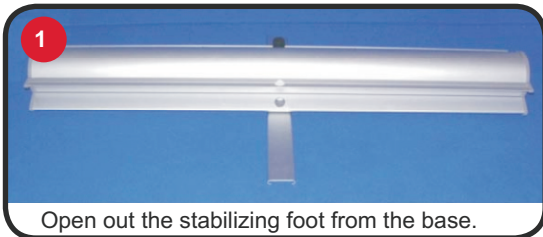

Kit Includes: base, bungee, pole set and carry bag (notshown)



1 Open out the stabilizing foot from the base.

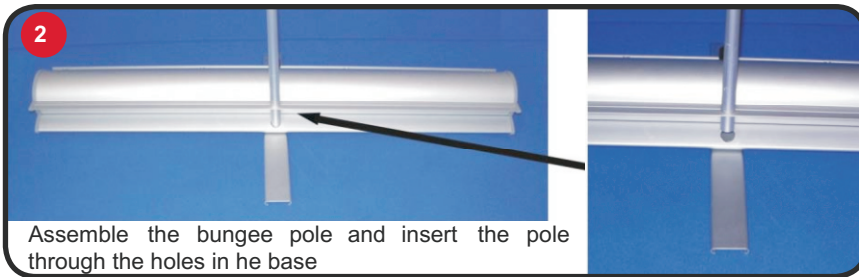

2 Assemble the bungee pole and insert the pole through the holes in the base



3 Lean the banner stand backwards and extend the banner by lifting the top rail until the complete image is visible.

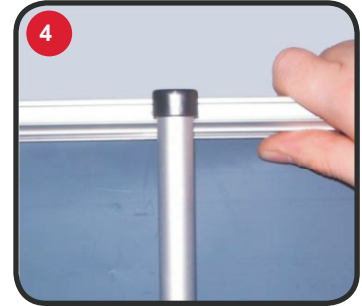

4 Finally, secure the banner by locating the top rail cup over the pole

Guidelines for Graphic Substrates

1. Material thickness must be between 0.0089" and 0.0118" in total
2. The substrate must be pliable and suitable for roller banner stands
3. After fitting, the graphic should be left for 24 hours before use to ensure the adhesive bonds sufficiently

Notes

Take care when lowering the banner (do not drop) to prevent damage to the graphic.